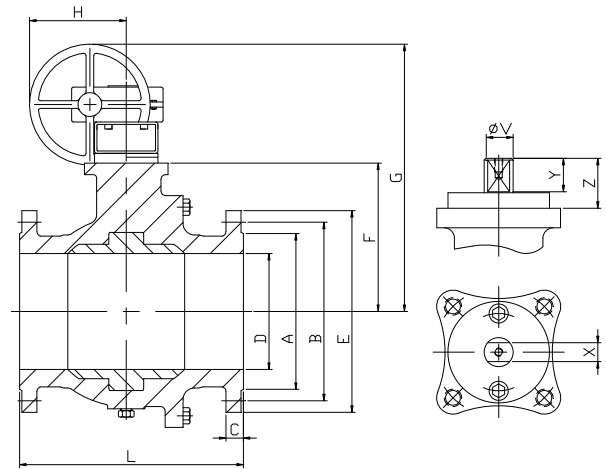
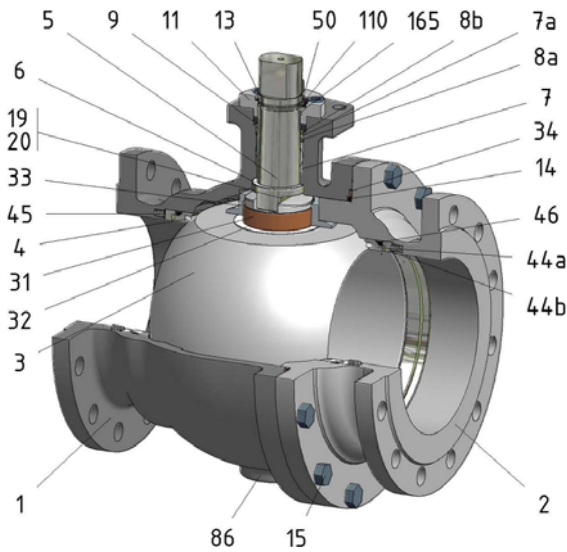

FIG.ZGS 06 SSSG PN40 DN150-300 F5



| Position | Description | Material |
|----------|----------------------|----------------------|
| 01 | Body 1 | S.S. 1.4408 |
| 02 | Body 2 | S.S. 1.4408 |
| 03 | Ball | S.S. 1.4408 |
| 04 | Seat | PTFE (modified)+CG |
| 05 | Stem | D.S.S. 1.4462 |
| 06 | Stem seal | PTFE (modified)+CG |
| 07 | Stem packing 1 | PTFE (modified)+CG |
| 07a | Stem packing 2 | Graphite |
| 08a | Gland packing 1 | S.S. 1.4401 |
| 08b | Gland packing 2 | S.S. 1.4401 |
| 09 | Spring washer | S.S. 1.4310 |
| 11 | Cover | S.S. 1.4408 |
| 13 | Cover bolt | A4-70 |
| 14 | Body seal 1 | PTFE (modified)+CG |
| 15 | Body bolt | A4-70 |
| 19 | Spring washer | Inconel X750 |
| 20 | Antistatic ball | Inconel 625 |
| 31 | Bearing | PTFE (modified) |
| 32 | Bearing disk | PTFE (modified)+FG |
| 33 | Support bearing | S.S. 1.4401 |
| 34 | Body seal 2 | Graphite |
| 44a | Ring seat 1 | S.S. 1.4401 |
| 44b | Ring seat 2 | S.S. 1.4401 |
| 45 | Spring seat | Inconel X750 |
| 46 | Seat seal | Graphite |
| 50 | Subjection ring | S.S. 1.4301 |
| 86 | Drain plug | S.S. 1.4401 |
| 86a | Vent plug | S.S. 1.4401 |
| 110 | Subjection ring seal | S.S. 1.4401 Nitrided |
| 165 | Stem bearing | PTFE (modified)+FG |

General features

Full trunnion.
Split body.
Full bore.
Soft seat.
Bidirectional.
Spring loaded seat system.
Anti Blow out proof stem.
Autoadjustable packing.
Anti static device.
Self-cavity pressure relief.

Standards

Top flange ISO 5211
Flanges EN 1092-01
Face to face EN 558
Testing EN-12266, ISO 5208
Design EN-12516, ISO 17292

Official approvals

CERTIFICATE FIRE SAFE
TA-LUFT VDI 2440
ISO 15848-1
ATEX 2014/34/EU
PED 2014/68/EU
SIL 3 CAPABLE

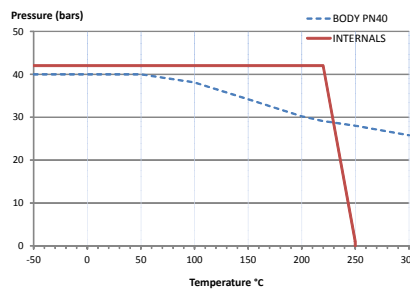

PEKOS GROUP CERTIFICATES:

ISO 9001-2008 / 2014/68/EU / API-6D



DIMENSIONS & Technical information

| DN | PN | D | L | E | A | B | C | F | H | G | V | X | Y | Z | n x d | ISO 5211 | Torque | MAST | Weight |
|-----|----|-----|-----|-----|-----|-----|----|-----|-----|-----|----|----|----|----|---------|----------|--------|--------|--------|
| 150 | 40 | 150 | 350 | 300 | 218 | 250 | 28 | 175 | 271 | 506 | 36 | 27 | 35 | 50 | 8 x 26 | F12 | 875 | 2356,2 | 83 |
| 200 | 40 | 200 | 400 | 375 | 285 | 320 | 34 | 245 | 336 | 627 | 48 | 36 | 40 | 63 | 12 x 30 | F14 | 1364 | 5585,0 | 147 |
| 250 | 40 | 250 | 450 | 450 | 345 | 385 | 38 | 285 | 355 | 673 | 48 | 36 | 40 | 63 | 12 x 33 | F14 | 1794 | 5585,0 | 254 |
| 300 | 40 | 300 | 500 | 515 | 410 | 450 | 42 | 336 | 355 | 724 | 48 | 36 | 40 | 63 | 16 x 33 | F14 | 2187 | 5585,0 | 372 |

** Depending on service conditions.

* Dimensions are in mm.

* Torque & MAST are in Nm.

* Weight is in Kilogram

* Torque values have been measured ΔP at maximum rating at room temperature

DS-2519
Rev.5